

attività extra

1. “**adottare**” una struttura **reale**
2. modellarla con **vincoli** e **tratti** lineari
3. **risolverla** con i metodi via via studiati

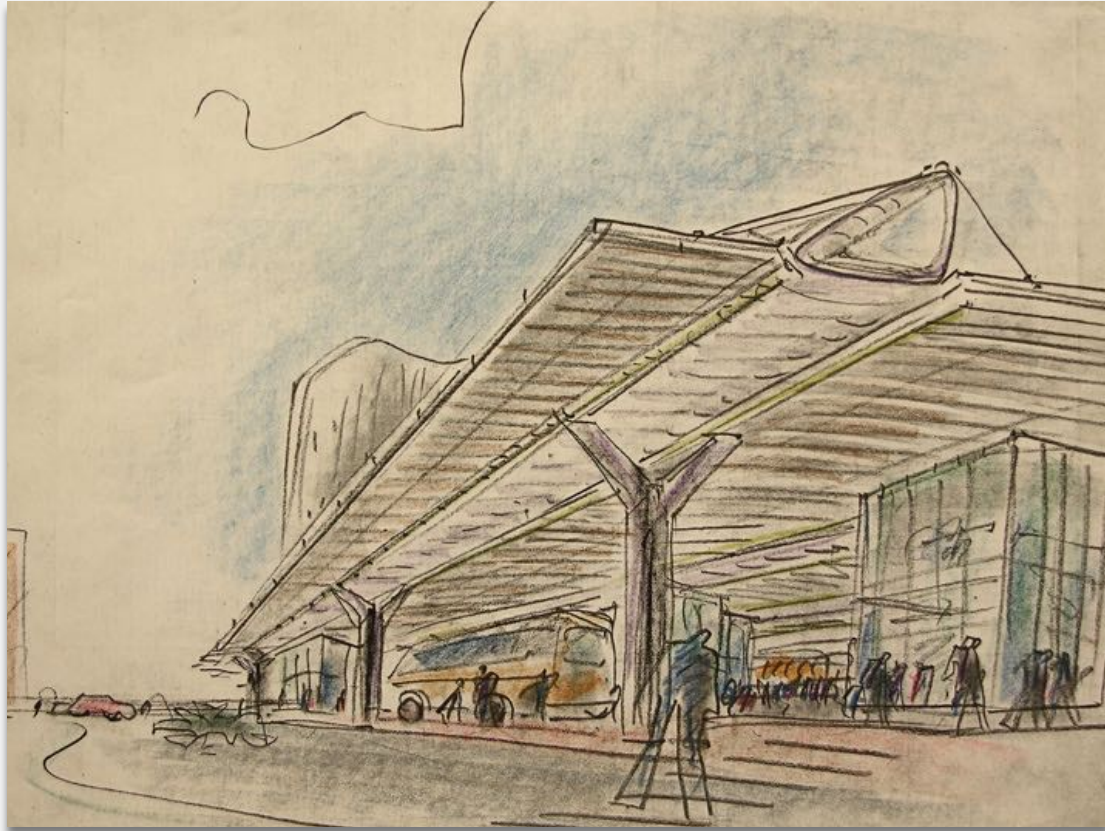

stazione Rogoredo, pensilina (arch. Mangiarotti)

attività extra (da completare prima dell'orale)

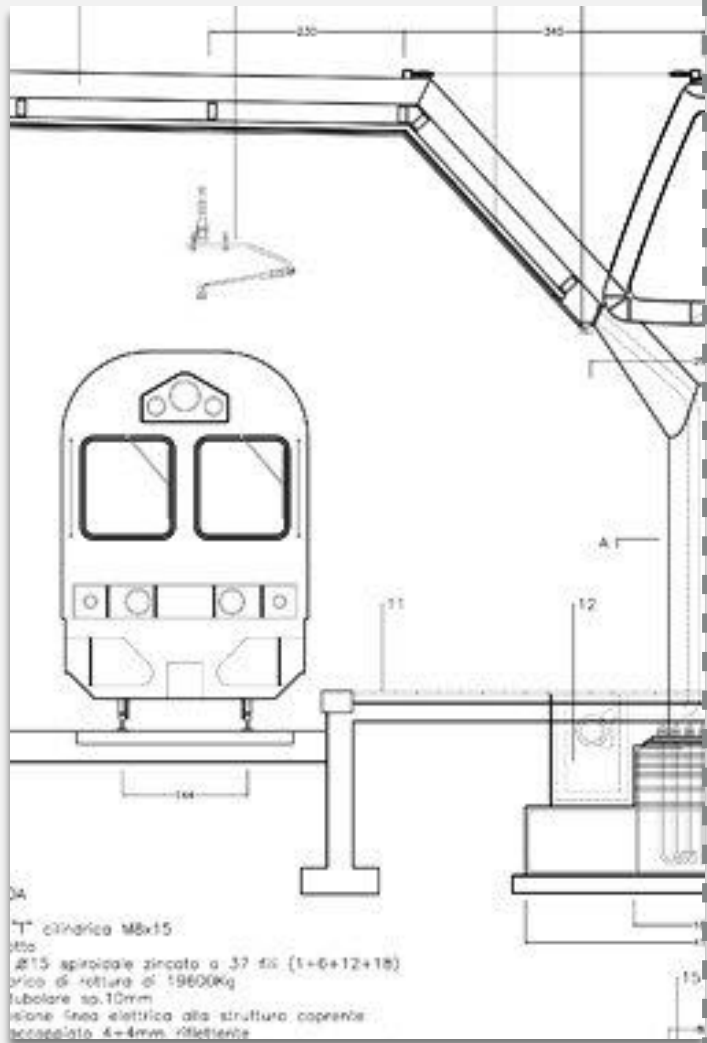

stazione Rogoredo, pensilina (arch. Mangiarotti)

attività extra (da completare prima dell'orale)

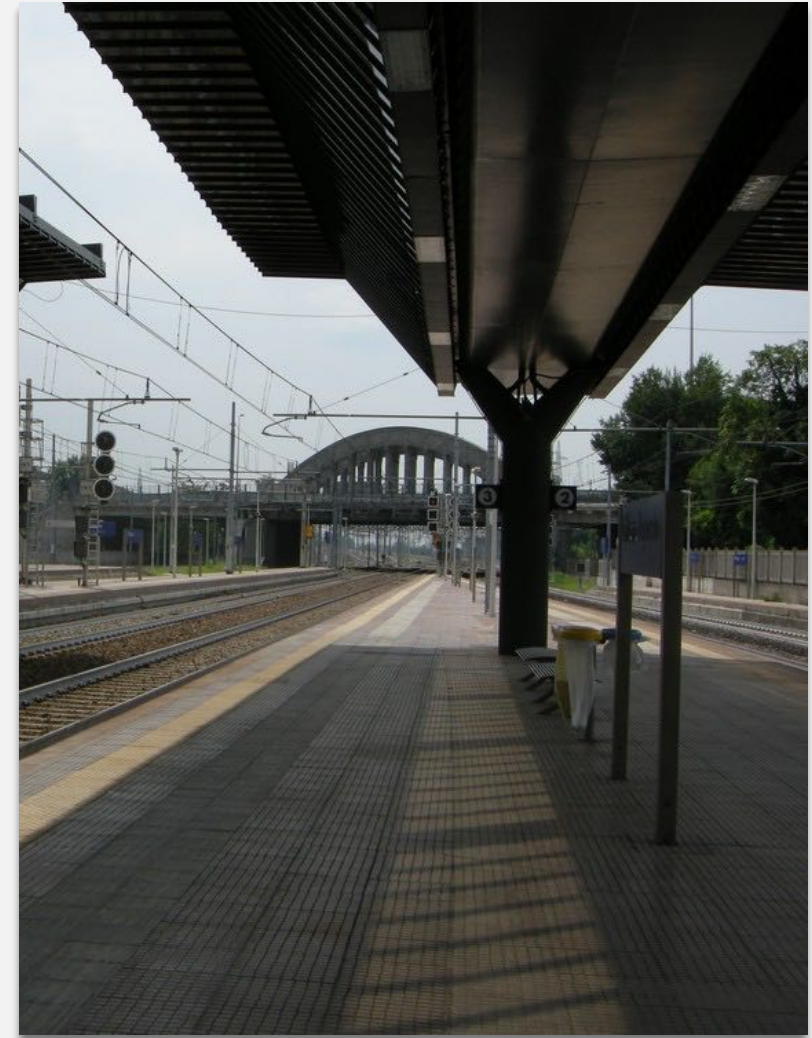
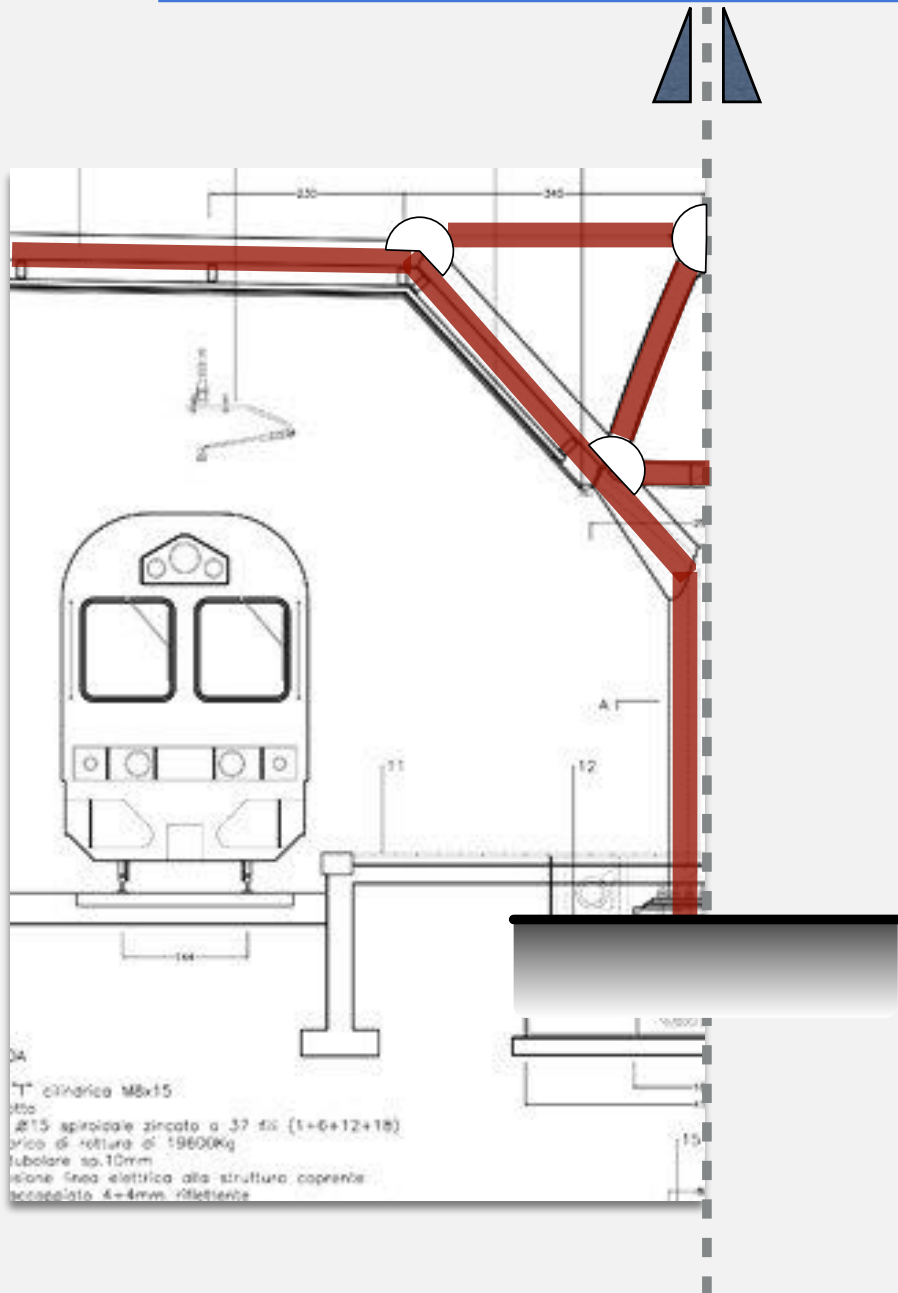

stazione Rogoredo, pensilina (arch. Mangiarotti)

attività extra (da completare prima dell'orale)

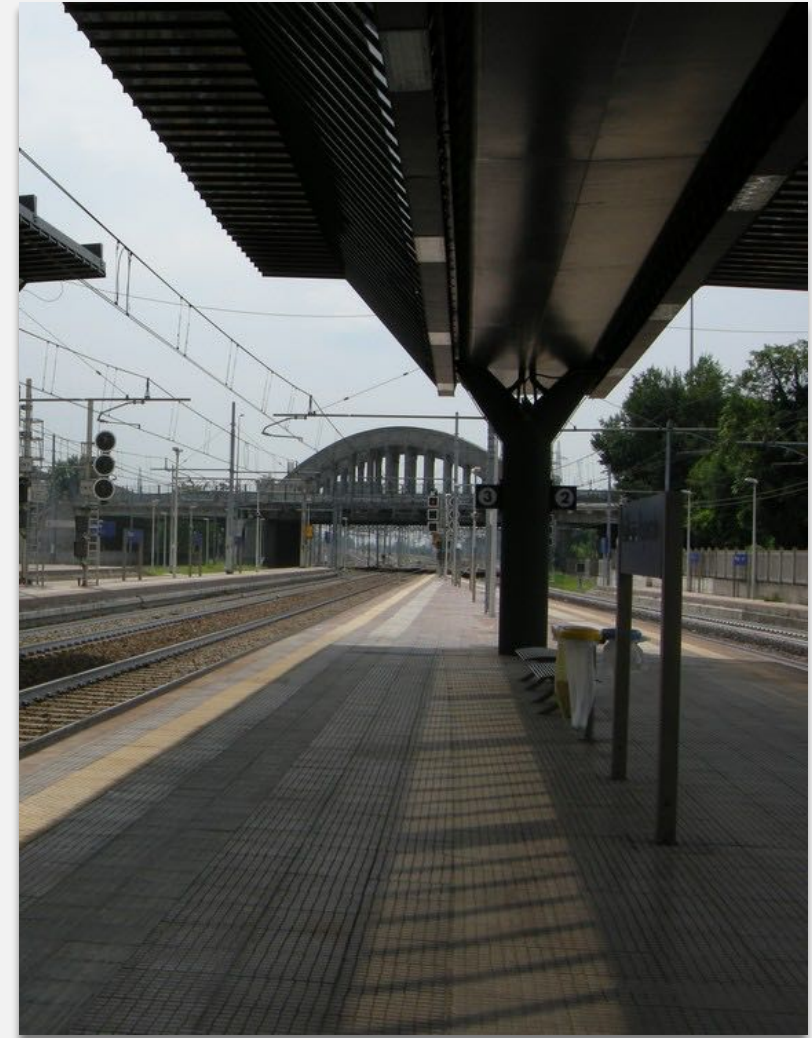
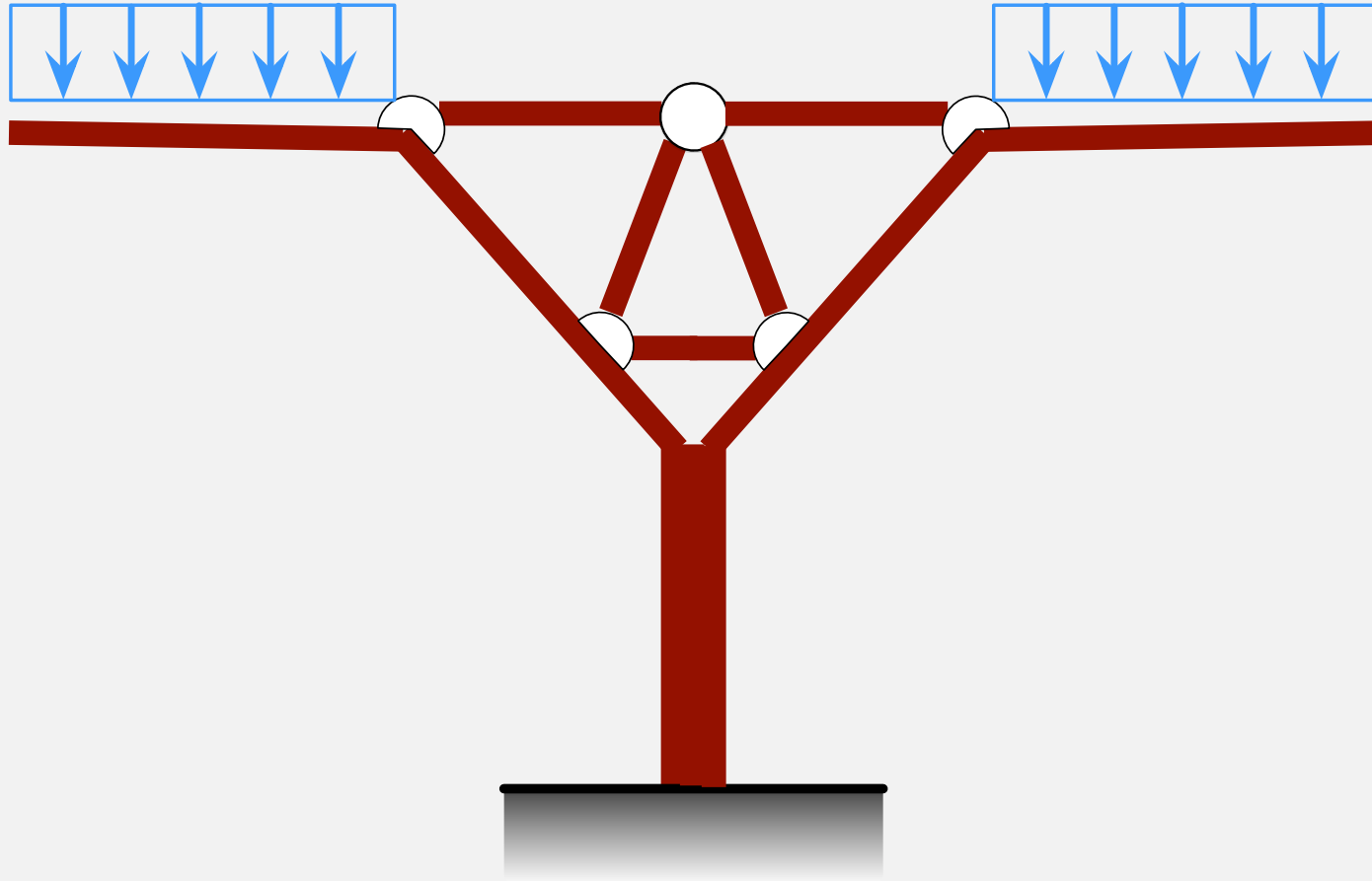

stazione Rogoredo, pensilina (arch. Mangiarotti)



1. Louis Kahn, *Lucernario Kimbell Art Museum*, 1971



2. Società Belga, *Ponte dell'Industria*, 1862-1863



3. Passerella ciclopedonale, Lago di Cavazzo



4. Pier Luigi Nervi, *Stadio Berta*, 1930



5. Richard Rogers, *Madrid-Barajas Airport*, 1999



6. Ben Van Berkel, *Ponte Erasmo*, 1996



7. Riccardo Morandi, *Viadotto Polcevera*, 1963



8. Affonso Eduardo Reidy, *MAM di Rio de Janeiro*, 1948



9. Michele De Lucchi, *Lampada Tolomeo per Artemide*



10. Cesar Pelli, *Torri Petronas*, 1992



11. Pier Luigi Nervi, *Stadio Flaminio*, 1959

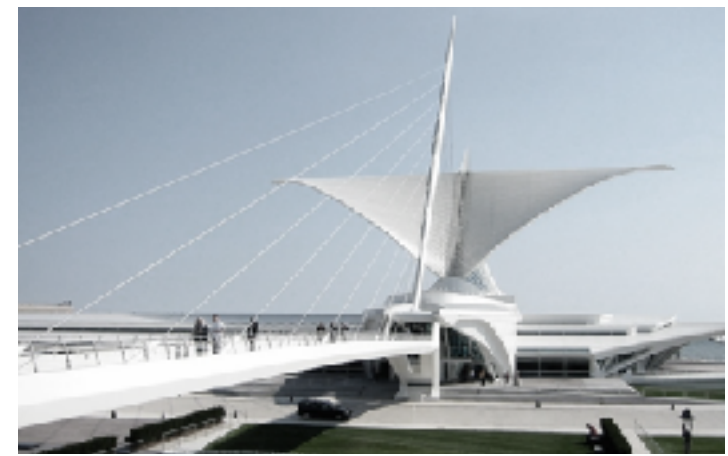

12. Santiago Calatrava, *MAM Quadricci Pavillion*, 2001

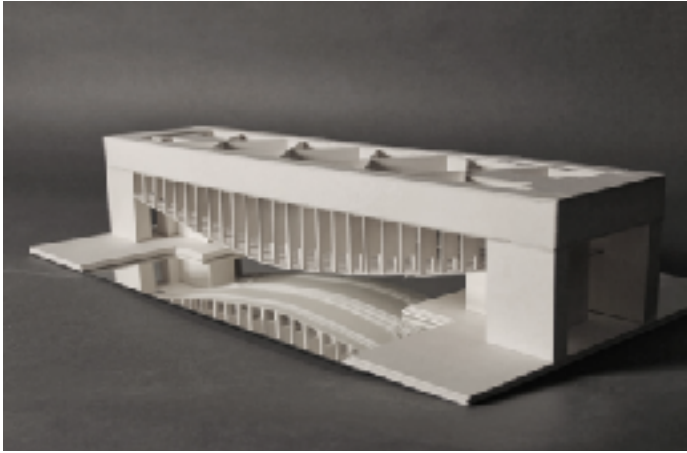

13. Louis Kahn, *Palazzo dei Congressi*, Venezia, 1972



14. WilkinsonEyre, *Gatwick Pier 6 Connector*, 1996



15. Santiago Calatrava, *Lyon-St Exupéry Airport Railway Station*, 1994



16. Strasky, Husty and Partners Ltd., *Olomuc Bridge*, 2007



17. E. Montuori, L. Calini, A. Vitellozzi, M. Castellazzi, V. Fadigati, A. Pintonello, *Edificio di Testa Stazione Termini*, 1950



18. Viadotto Platano



19. Ponte Sul Piave



20. Viadotto Platano



21. Forth Bridge



22. Stazione di Rogoredo



23. Sedia Zig Zag



24. Scala ArqMov



25. Pensilina Ex Mattatoio



26 . Società Belga, *Ponte dell'Industria Parte Bassa*, 1862-1863



27. Aula Paolo IV



28. Cattedrale di St. Mary



29. Padiglione Conferenze UNESCO



18. SOM Architect, *Hajj Terminal Jeddah*, 1981

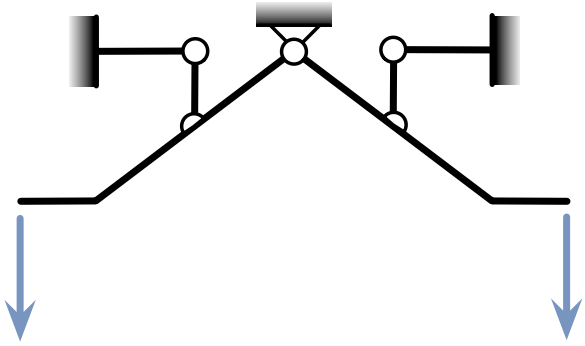

1. Louis Kahn, *Lucernario Kimbell Art Museum*,

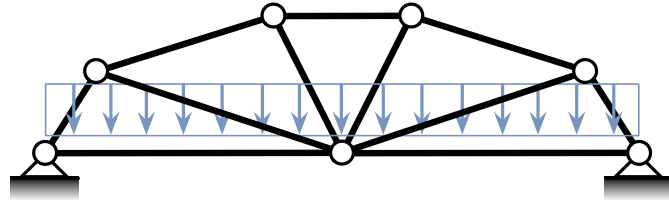

2. Società Belga, *Ponte dell'Industria*, 1862-1863

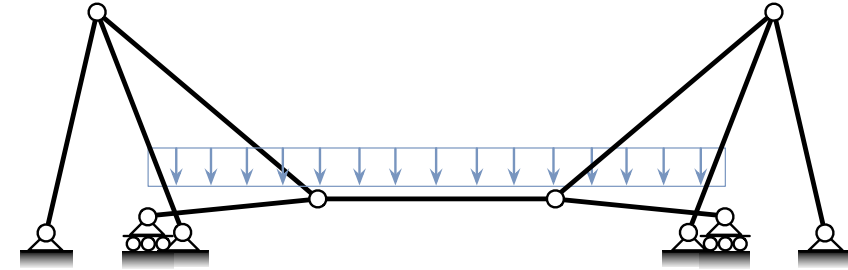

3. Passerella ciclopedonale, Lago di Cavazzo

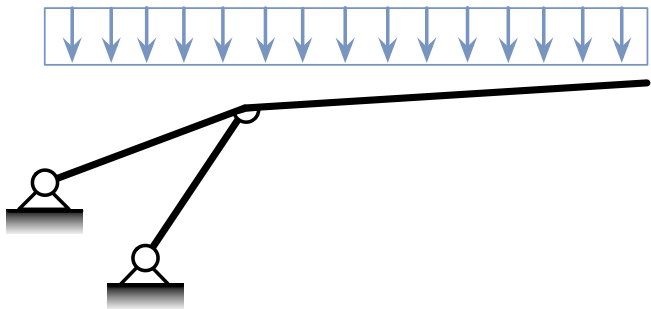

4. Pier Luigi Nervi, *Stadio Berta*, 1930 (copertura)

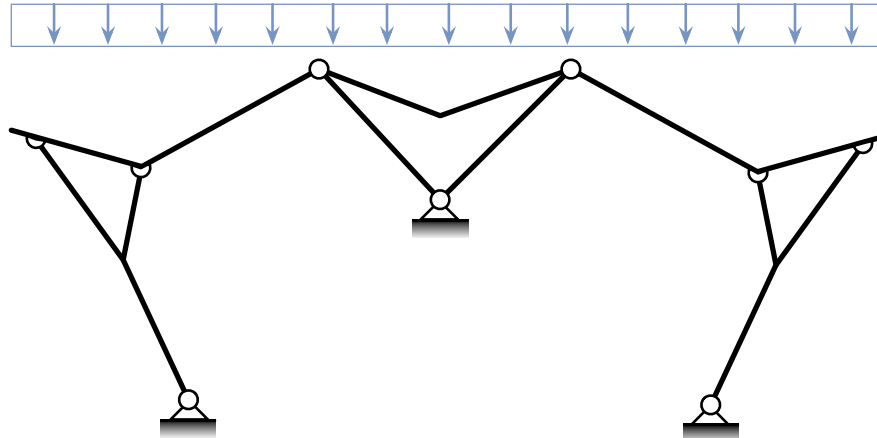

5. Richard Rogers, *Madrid-Barajas Airport*, 1999

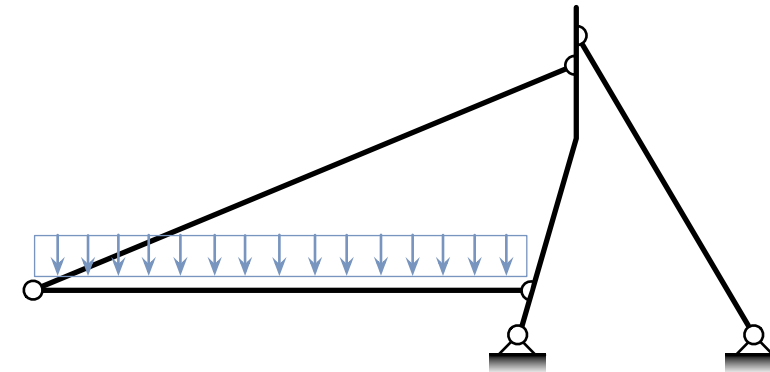

6. Ben Van Berkel, *Ponte Erasmo*, 1996

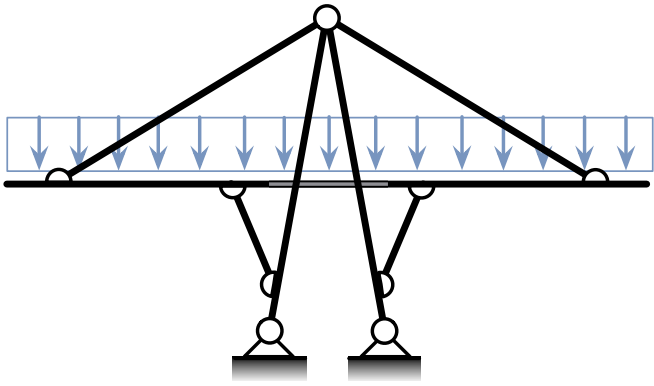

7. Riccardo Morandi, *Viadotto Polcevera*, 1963

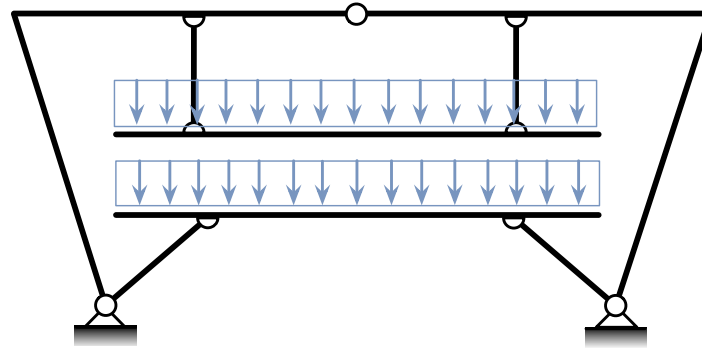

8. Afonso Eduardo Reidy, *MAM di Rio de Janeiro*,

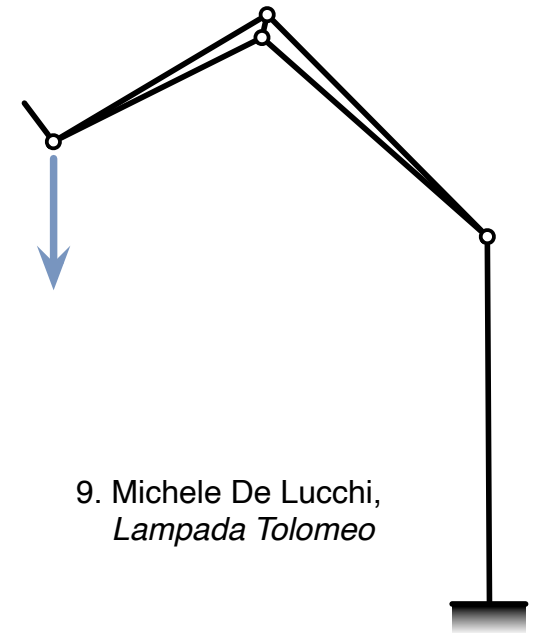

9. Michele De Lucchi, *Lampada Tolomeo*

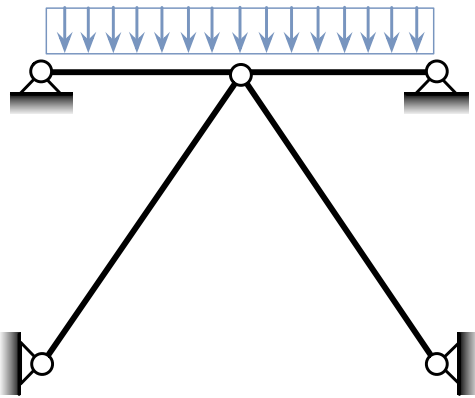

10. Cesar Pelli, *Torri Petronas*, 1992

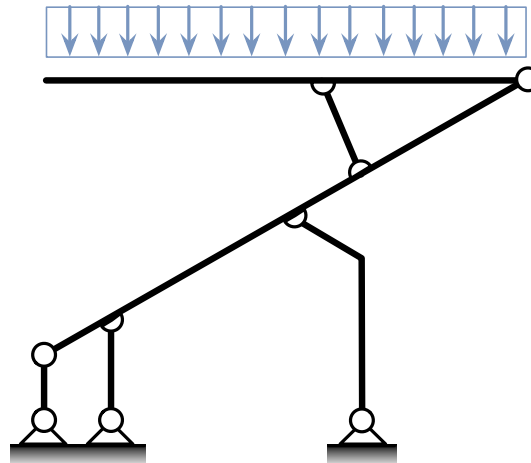

11. Pier Luigi Nervi, *Stadio Flaminio*, 1959

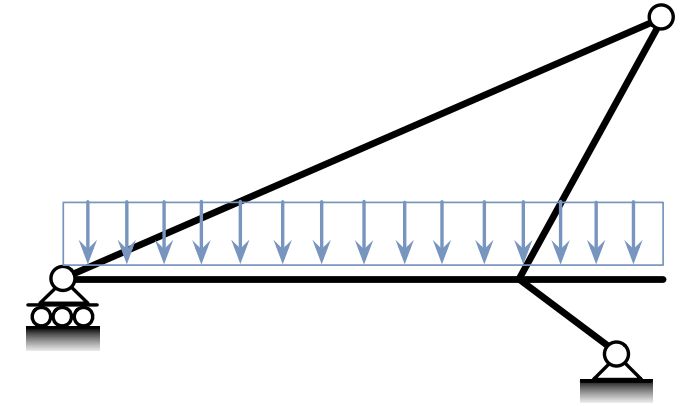

12. Santiago Calatrava, *MAM Quadricci Pavillion*,

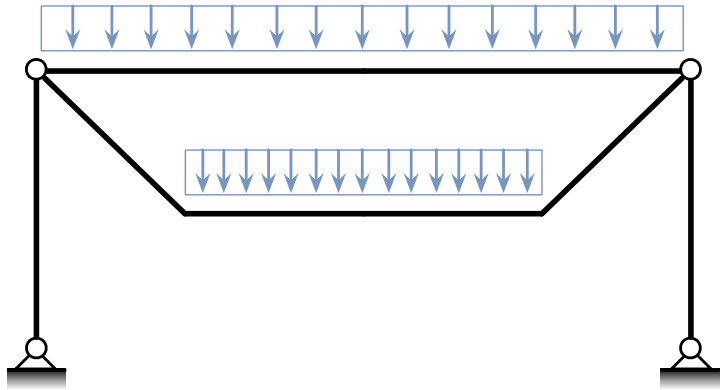

13. Louis Kahn, *Palazzo dei Congressi*, Venezia

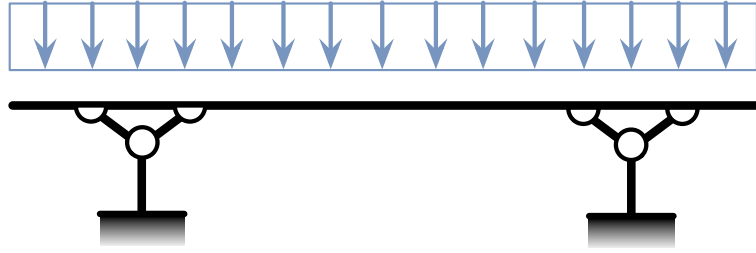

14. WilkinsonEyre, *Gatwick Pier 6 Connector*, 1996

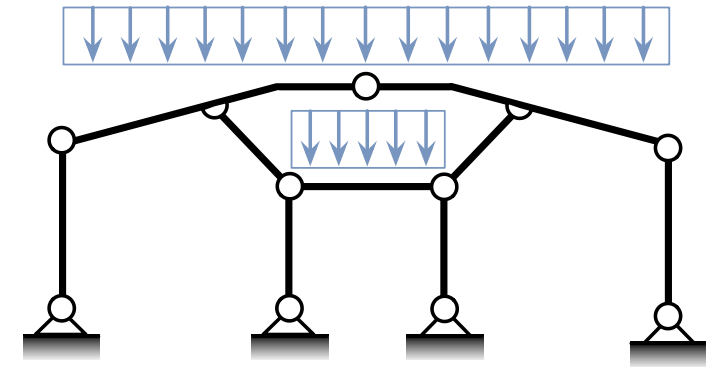

15. Calatrava, *Lyon-St Exupéry Airport*

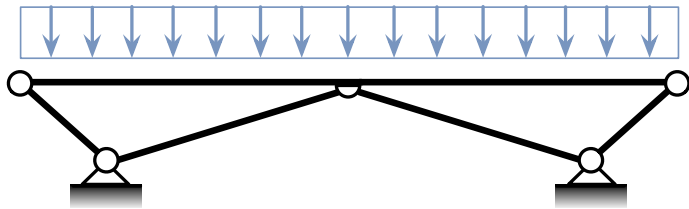

16. Strasky, et al. *Olomuc Bridge*, 2007

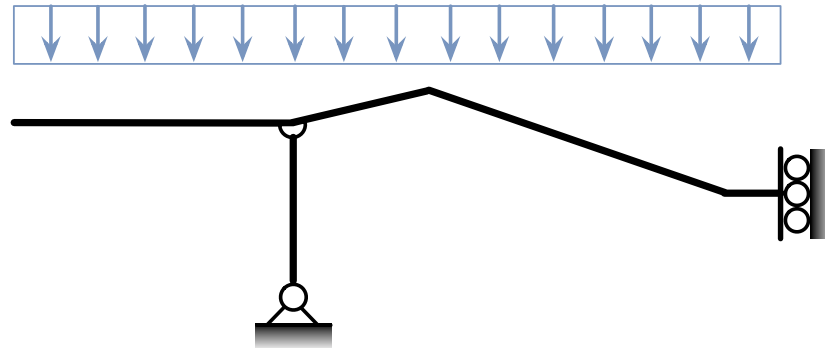

17. E. Montuori, et al, *Stazione Termini*

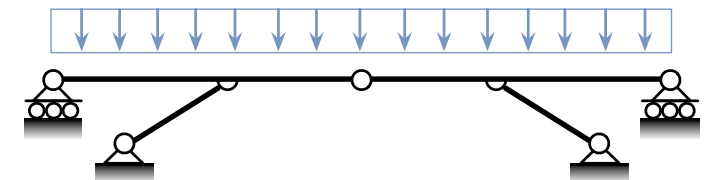

18. Viadotto Platano

“adotta” una struttura

0. Ricerca Materiale

1. Disegno Strutturale:

- dimensioni geometriche approssimate (in forma parametrica)
- distribuzione dei carichi

2. Calcolo delle reazioni vincolari

3. Riconoscimento di eventuali soluzioni “notevoli”

(p.e., trave appoggiata, mensola, arco a tre cerniere, ecc.)

4. Tracciamento dei diagrammi della sollecitazione

5. Riconoscimento di una reazione iperstatica significativa

6. Analisi a Collasso